

TREX700 SERIES ONE-WAY BEARING MOUNT UPGRADE  
AT700-OWBM (SS 440C, HRC60)

STEP 1: ONE-WAY BEARING MOUNT ASSEMBLY INSTALLATION  
NOTE: RADIAL-BALL BEARING PRE-INSTALLED BY PRODUCTION FACILITY

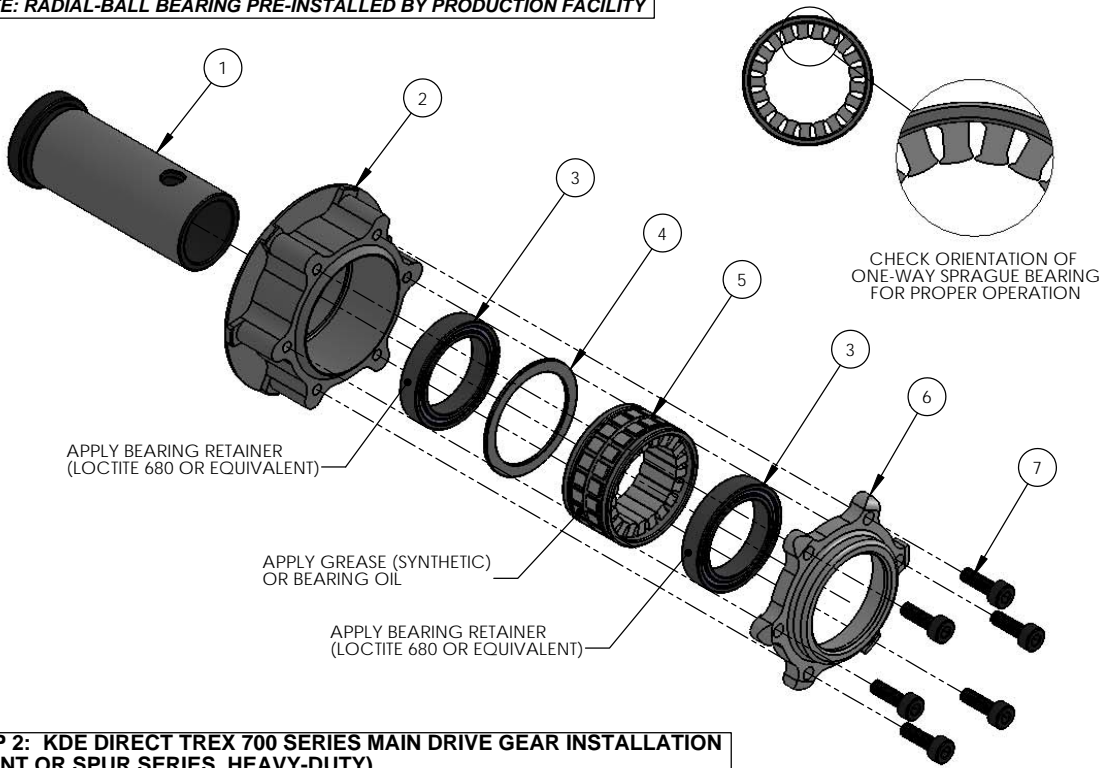

STEP 2: KDE DIRECT TREX 700 SERIES MAIN DRIVE GEAR INSTALLATION  
(SLANT OR SPUR SERIES, HEAVY-DUTY)

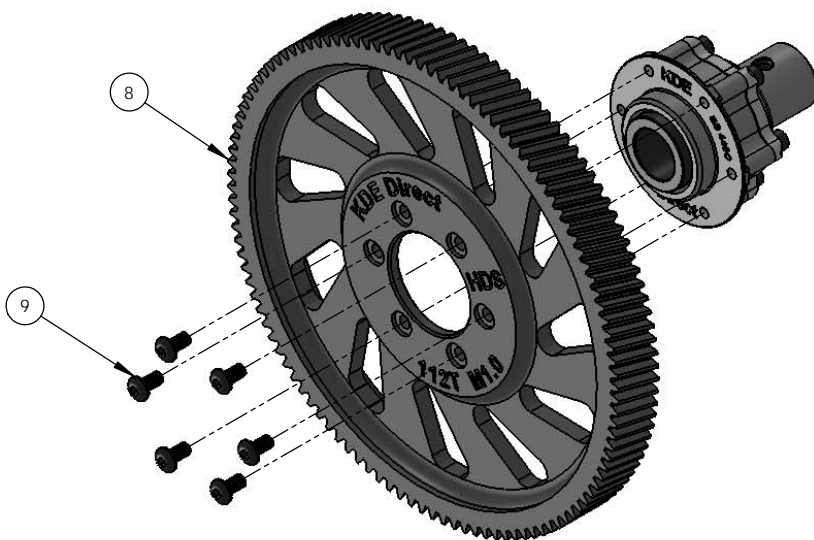

ITEM NO.	DESCRIPTION	QTY.
1	ALIGN TREX 700 SERIES ONE-WAY BEARING SHAFT (PROVIDED IN ORIGINAL KIT OR SOLD SEPARATELY)	1
2	KDE DIRECT TREX 700 SERIES ONE-WAY BEARING MOUNT UPGRADE (STAINLESS STEEL 440C, HARDENED TO BEARING-QUALITY HRC60)	1
3	6702ZZ RADIAL-BALL BEARING	2
4	ALIGN TREX 700 SERIES ONE-WAY BEARING SPACER (OPTIONAL, PROVIDED IN ORIGINAL KIT, HN7002A ONLY)	1
5	ALIGN TREX 700 SERIES ONE-WAY SPRAGUE BEARING (PROVIDED IN ORIGINAL KIT)	1
6	ALIGN TREX 700 SERIES ONE-WAY BEARING COVER (PROVIDED IN ORIGINAL KIT)	1
7	M2.5 x 0.45 x 8MM SOCKET HEAD CAP SCREW	6
8	KDE DIRECT TREX 700 SERIES MAIN DRIVE GEAR (SOLD SEPARATELY, AT700-MDGM1-XXX SLANT OR STANDARD SERIES)	1
9	M3 x 0.5 x 6MM BUTTON HEAD SOCKET HEAD CAP SCREW	6

**NOTE:** THE ONE-WAY BEARING MOUNT UPGRADE PROVIDES THE IDEAL SOLUTION TO THE ONE-WAY BEARING ASSEMBLY FAILURES COMMON WITH THE STOCK TREX 700/800 DESIGN. BY UTILIZING A ONE-PIECE, HIGH-GRADE BEARING-QUALITY STAINLESS STEEL 440C MATERIAL CONSTRUCTION, PRECISION CNC-MACHINED AND SECONDARY HARDENED TO HRC60 RATING; THE NEW DESIGN PROVIDES A ROBUST AND FAILURE-FREE SETUP FOR YOUR 700-CLASS HELICOPTER. THE UPGRADE IS A DROP-IN FIT FOR ALL 700- AND 800-SERIES HELICOPTERS.

**MAKE SURE AND APPLY THREAD LOCKER (LOCTITE 243 OR EQUIVALENT) TO ALL FASTENERS DURING ASSEMBLY.** IN ADDITION, DUE TO THE STAINLESS STEEL CONSTRUCTION OF THE UPGRADE, THE RISK OF STRIPPING THREADS FOR MULTIPLE GEAR CHANGES AND MAINTENANCE WHEN TIGHTENING ALL HARDWARE IS GREATLY REDUCED.



www.KDEDirect.com  
AT700-OWBM