

SYNERGY E6/E7/N5/N5c SERIES FLYBARLESS MAIN ROTOR HOUSING SE6/7-MRHFB (AL 6061-T6)

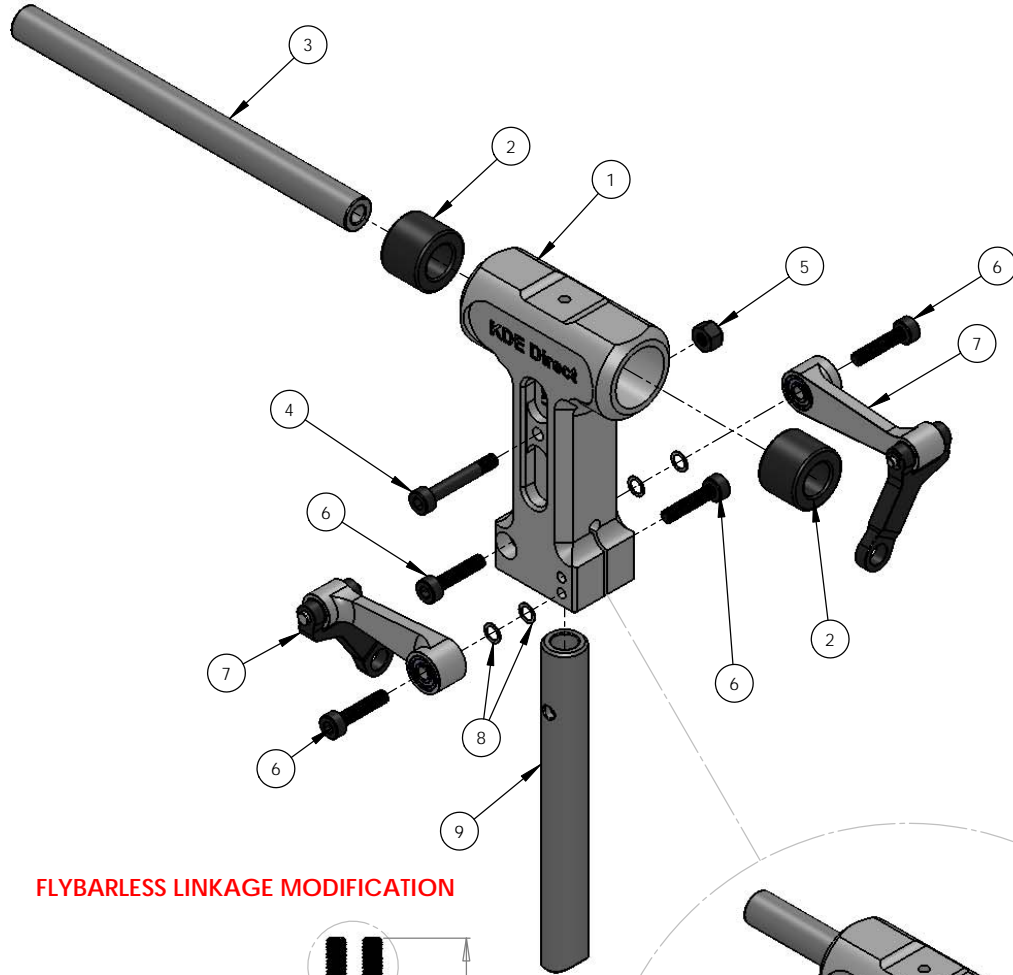

FLYBARLESS LINKAGE MODIFICATION

REDUCE LINKAGE LENGTH EQUAL ON BOTH SIDES TO REACH 63MM TARGET

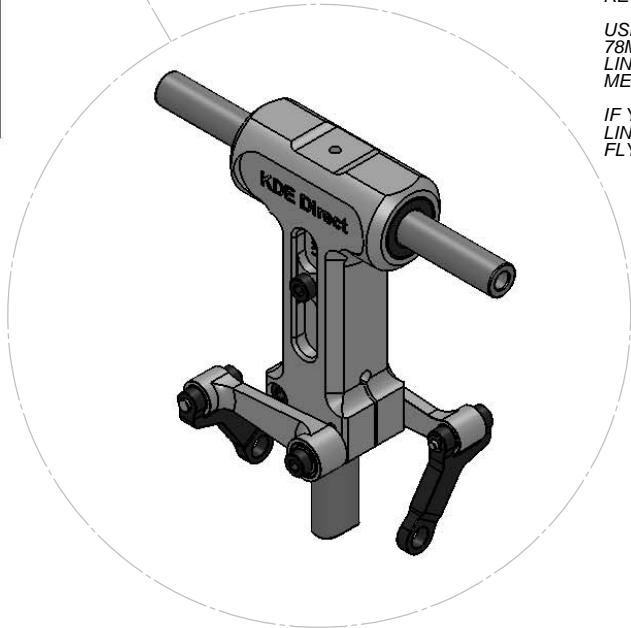
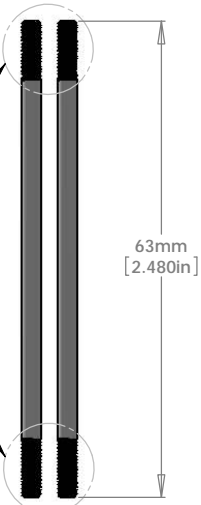

ITEM NO.	DESCRIPTION	QTY.
1	KDE DIRECT SYNERGY E6/E7/N5/N5c SERIES FLYBARLESS MAIN ROTOR HOUSING	1
2	SYNERGY SERIES RUBBER DAMPER (SOLID HEAD) (PROVIDED IN ORIGINAL KIT, 606-803)	2
3	SYNERGY SERIES FEATHERING SHAFT (HEAD AXLE) (PROVIDED IN ORIGINAL KIT, 120-114)	1
4	M3 x 0.5 x 20MM SOCKET HEAD COLLAR CAP SCREW (PROVIDED IN ORIGINAL KIT, 100-320A)	1
5	M3 x 0.5 NYLON-INSERT LOCKNUT (PROVIDED IN ORIGINAL KIT, 100-351)	1
6	M3 x 0.5 x 14MM SOCKET HEAD CAP SCREW	4
7	SYNERGY SERIES FLYBARLESS WASHOUT CONTROL ARM (INCLUDED IN ORIGINAL KIT OR SOLD SEPARATELY, 620-214)	2
8	M3 ROUND HOLE SHIM (INCLUDED IN ORIGINAL KIT, 106-301)	4
9	SYNERGY E6/E7 SERIES MAIN SHAFT (INCLUDED IN ORIGINAL KIT, 310-140)	1

NOTE: THE FLYBARLESS MAIN ROTOR HOUSING ENCOMPASSES THE LATEST TECHNOLOGIES FOR OPTIMUM SETUP OF THE FLYBARLESS MECHANICS. WITH DIRECT MOUNTED WASHOUT ARMS AND A SOLID M3 CLAMP DESIGN OF THE ROTOR HEAD TO THE MAIN SHAFT, THE NEW DESIGN IS CAPABLE OF PROVIDING THE HIGHEST-PRECISION CONTROL POSSIBLE FOR THE FLYBARLESS ELECTRONICS.

MAKE SURE TO USE LOCTITE 243 (BLUE) OR EQUIVALENT ON ALL METAL-TO-METAL FASTENERS TO PREVENT LOOSENING DURING FLIGHT. TO ACHIEVE THE BEST POSSIBLE SETUP AND PERFECT ALIGNMENT OF THE FLIGHT MECHANICS, IT IS RECOMMENDED TO USE THE FOLLOWING SYNERGY FLYBARLESS COMPONENTS:

SYNERGY E6/E7/N5/N5c SERIES

MAIN SHAFT: 310-140, SYNERGY E6/E7 MAIN SHAFT

FLYBARLESS GRIPS: 520-514/520-513, SYNERGY FBL MAIN BLADE GRIP SET

WASHOUT ARMS: 620-214, SYNERGY FBL WASHOUT CONTROL ARM

LINKAGES: 107-078, SYNERGY FBL 78MM RODS (**MODIFICATION REQUIRED**)

LINKAGE MODIFICATION INSTRUCTIONS: DUE TO THE LOWERED GEOMETRY OF THE KDE DIRECT FLYBARLESS MAIN ROTOR HOUSING (APPROXIMATELY 16MM LOWER THAN THE STOCK ROTOR HEAD INSTALLATION), MODIFICATION TO THE 78MM LINKAGES IS REQUIRED.

USING A DREMEL CUT-OFF WHEEL, GRINDER, OR SAW; REDUCE THE LENGTH OF THE 78MM LINKAGES TO 63MM. THIS WILL ALLOW FOR PROPER ADJUSTMENT OF THE LINKAGES TO PROVIDE THE CORRECT PITCH RANGE ACCORDING TO THE HELICOPTER MECHANICS AND MANUAL INSTRUCTIONS.

IF YOU ARE UNABLE TO MODIFY THE STOCK LINKAGES, SHORTER 2.5MM DIAMETER LINKAGES CAN BE SUBSTITUTED; SUCH AS THE ALIGN TREX 600E PRO SERIES FLYBARLESS LINKAGES (ALIGN PART #H60231).

www.KDEDirect.com



www.KDEDirect.com
SE6/7-MRHFB