

# FUSION50 BATTERY TRAY SYSTEM AND TRAY ASSEMBLY OF50-BTS/BTS-TA (AL 6061-T6)

## STEP 1

MODIFY STOCK CARBON SIDE FRAMES FOR INSTALLATION

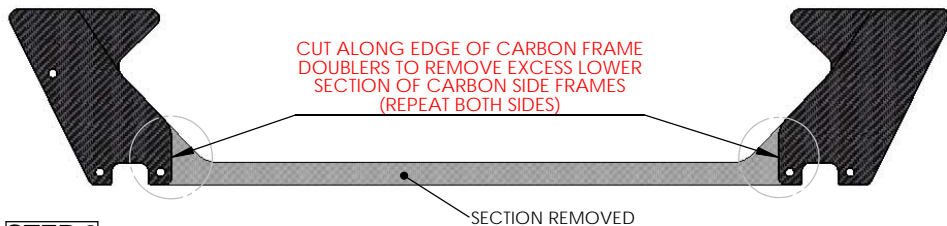

## STEP 2

INSTALL BATTERY TRAY SYSTEM MOUNTS AND BUILD BATTERY TRAY ASSEMBLY

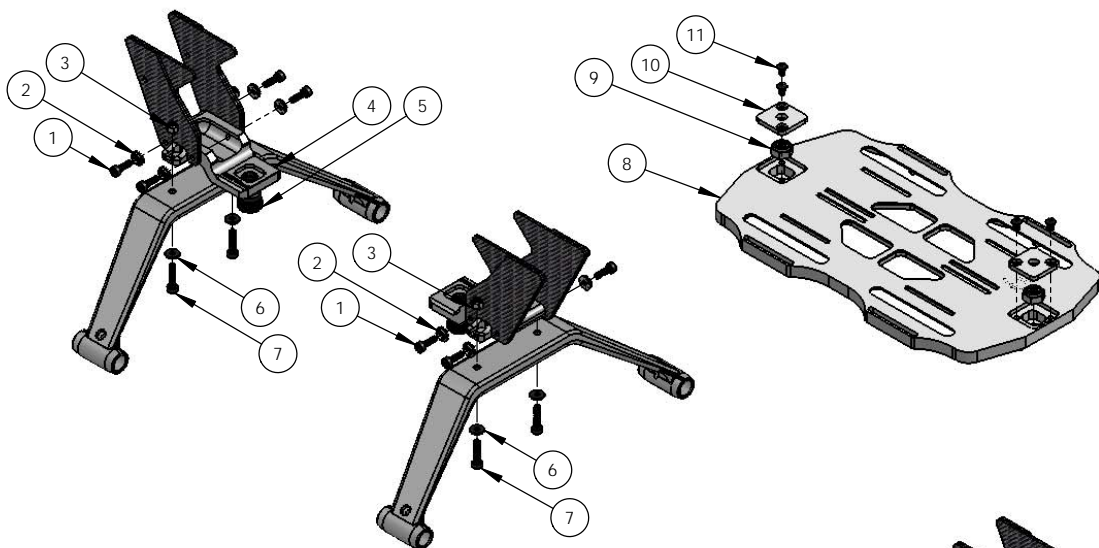

## STEP 3

INSTALL BATTERY TRAY ASSEMBLY ONTO SYSTEM MOUNTS FOR FLIGHT

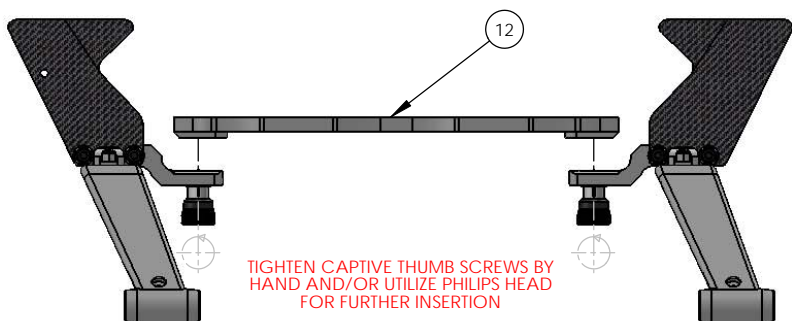

ITEM NO.	DESCRIPTION	QTY.
1	M3 x 0.5 x 10MM SOCKET HEAD CAP SCREW	8
2	OUTRAGE FINISHING "C" WASHER M3 (PROVIDED IN ORIGINAL KIT)	8
3	M3 x 0.5 NYLON-INSERT LOCKNUT (PROVIDED IN ORIGINAL KIT)	4
4	KDE DIRECT FUSION 50E SERIES BATTERY TRAY SYSTEM MOUNT	2
5	KDE DIRECT FUSION 50E SERIES BATTERY TRAY SYSTEM MOUNT CAPTIVE THUMB-SCREW, 8-32	2
6	OUTRAGE FLAT WASHER M3 (PROVIDED IN ORIGINAL KIT)	4
7	OUTRAGE M3 x 0.5 x 14MM SOCKET HEAD CAP SCREW (PROVIDED IN ORIGINAL KIT)	4
8	KDE DIRECT FUSION 50E SERIES BATTERY TRAY SYSTEM BATTERY TRAY	1
9	8-32 NYLON-INSERT JAM LOCKNUT	2
10	KDE DIRECT FUSION 50E SERIES BATTERY TRAY SYSTEM BATTERY TRAY COVER PLATE	2
11	M2.5 x 0.45 x 4MM BUTTON HEAD SOCKET HEAD CAP SCREW	4
12	KDE DIRECT FUSION 50E SERIES BATTERY TRAY SYSTEM BATTERY TRAY ASSEMBLY (INCLUDED AND SOLD SEPARATELY)	1

**NOTE:** THE FUSION 50E SERIES BATTERY TRAY SYSTEM PROVIDES A SIGNIFICANT INCREASE IN FRAME STIFFNESS, BATTERY RETENTION/PROTECTION, AND AN INNOVATIVE INSTALLATION ASSEMBLY FOR THE BEST FLIGHT EXPERIENCE. WITH A LOWERED-TRAY ORIENTATION, SETUPS UP TO 12S-5000MAH LIPO POWER SYSTEMS CAN BE USED FOR HIGH-POWER, HIGH-INTENSITY FLIGHTS NEVER BEFORE POSSIBLE WITH THE STOCK PLATFORM.

**STEP 1:** USING A DREMEL CUT-OFF WHEEL, SAW, OR OTHER CUTTING TOOL; CUT THE CARBON SIDE FRAMES USING THE EDGE OF THE CARBON FRAME DOUBLERS AS A GUIDE TO REMOVE THE EXCESS LOWER FRAME SECTION. REPEAT BOTH SIDES.

**STEP 2:** INSTALL THE BATTERY TRAY SYSTEM MOUNTS (CAPTIVE THUMB-SCREW PRE-INSTALLED) INTO THE SIDE FRAMES ACCORDING TO THE FIGURE SHOWN. MAKE SURE TO APPLY BLUE LOCTITE (243 OR EQUIVALENT) TO ALL SCREWS WHEN INSTALLING INTO CORRESPONDING ALUMINUM THREADS. IN ADDITION, POCKETS ARE PROVIDED FOR THE M3 NYLON-INSERT LOCKNUTS FOR EASY INSTALLATION OF THE LANDING SKID SETS.

**BATTERY TRAY ASSEMBLY:** POCKETS ARE PROVIDED FOR THE 8-32 NYLON-INSERT JAM LOCKNUTS AND RETAINED WITH THE INCLUDED BATTERY TRAY COVER PLATES (ALLOWING THE LOCKNUT TO PROPERLY FLOAT AND ALIGN TO THE CAPTIVE THUMB-SCREWS FOR EASY INSTALLATION).

**STEP 3:** INSTALL THE BATTERY TRAY ASSEMBLY ONTO SYSTEM MOUNTS FOR FLIGHT (LIPOS INSTALLED WITH PROVIDED RETAINING STRAPS). ALIGN THE LOWER BATTERY TRAY BOSS FEATURES ONTO THE PRECISION-MACHINED SYSTEM MOUNT POCKETS AND TIGHTEN CAPTIVE THUMB-SCREWS BY HAND AND/OR UTILIZE A PHILIPS HEAD SCREWDRIVER FOR FURTHER INSERTION.

**NOTE:** THE 8-32 NYLON-INSERT LOCKNUTS PROVIDE A VIBRATION-RESISTANT HOLD TO THE 8-32 CAPTIVE THUMB-SCREW. THE FIRST FEW INSTALLS WILL BE DIFFICULT TO ENGAGE FULLY BY-HAND UNTIL THE NYLON-INSERT BREAKS-IN. RECOMMENDED TO INSTALL THE TRAY AND REPEAT (5) TIMES USING A PHILIPS-HEAD SCREWDRIVER UNTIL THREADS ARE PRODUCED. ONCE BREAK-IN IS COMPLETED, THUMB-PRESSURE WILL BE ADEQUATE FOR FUTURE INSTALLS AND FULL-LOCK OF THE SYSTEM.

www.KDEDirect.com



www.KDEDirect.com  
OF50-BTS/BTS-TA